

# PRODUCT DATASHEET

## LN UO 1500 30 W 3000 K

LINEAR ULTRA OUTPUT | Surface luminaire with high luminous flux

---

### Areas of application

- Direct replacement for luminaires with fluorescent lamps
- Indoor applications
- Industrial and commercial halls
- Public areas
- Corridors, stairwells, basements



---

### Product benefits

- Replacement of conventional T8 luminaires with up to 7100 lm
- Energy savings up to 60 % (compared to luminaires that use fluorescent lamps)
- Robust structure with IK08
- 5 years guarantee

---

### Product features

- Very high luminous efficacy: up to 125 lm/W
- Robust metal housing and PC diffuser
- Wiring at back side of luminaire
- Through wiring possible



---

**TECHNICAL DATA****Electrical data**

Nominal wattage	30.00 W
Nominal voltage	220...240 V
Mains frequency	50...60 Hz
Nominal current	145 mA
Inrush current	40 A
Inrush current time $T_{h50}$	120 $\mu$ s
Max. no. of lum. on circuit break. B16 A	21
Max. no. of lum. on circuit break. C10 A	17
Max. no. of lum. on circuit break. C16 A	27
Power factor $\lambda$	> 0.90
Total harmonic distortion	$\leq$ 15 %
Protection class	I
Operating mode	Integrated LED driver

**Photometrical data**

Luminous flux	3500 lm
Luminous efficacy	115 lm/W
Color temperature	3000 K
Light color (designation)	Warm White
Color rendering index Ra	$\geq$ 80
Standard deviation of color matching	$\leq$ 5 sdc <sub>m</sub>
Photobiological safety group acc. to EN62778	RG0
Beam angle	110 °

**Dimensions & Weight**

Length	1458.00 mm
Width	62.00 mm
Height	74.00 mm
Product weight	1800.00 g

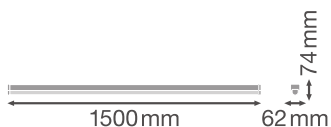

### Materials & Colors

Product color	White
Housing color	White
Body material	Steel
Cover material	Polycarbonate (PC)
Light emitting surface material	Polycarbonate (PC)
Glow Wire Test according to IEC 60695-2-12	650 °C
Mercury content	0.0 mg

### Application & Mounting

Ambient temperature range	-10...+40 °C
Type of connection	Screwless terminal
Type of protection	IP20
Protection class IK (shock resistance)	IK08
Dimmable	No
Mounting type	Surface
Mounting location	Ceiling / Wall
Application environment	Indoor
LED module replaceable	Not replaceable
With light source	Yes

### Lifespan

Lifespan L70/B50 at 25 °C	50000 h <sup>1)</sup>
Lifespan L80/B10 at 25 °C	40000 h <sup>1)</sup>
Lifespan L90/B10 at 25 °C	30000 h
Number of switching cycles	100000

<sup>1)</sup> t[h]: L70 / B50 @ 25 °C (Ta), t[h]: L80 / B10 @ 25 °C (Ta), t[h]: L90 / B10 @ 25 °C (Ta)

### Certificates & Standards

Standards	CE / CB / ENEC / TÜV SÜD / EAC
-----------	--------------------------------

Luminaire with limited surface temperature, "D sign"	No
Ball shot safe	No

**Additional product data**



Number of illuminants	-
-----------------------	---

**EQUIPMENT / ACCESSORIES**





- Mounting screws and dowels included

**DOWNLOAD DATA**

**Documents and certificates**

	User instruction
	Addon Technical Information
	On-Pack-Info
	Declarations Of Conformity CE

**Photometric and lighting design files**

	IES file (IES)
	LDT file (Eulumdat)
	ULD file (DIALux)
	UGR file (UGR table)

**LOGISTICAL DATA**

Product code	Packaging unit (Pieces/Unit)	Dimensions (length x width x height)	Gross weight	Volume
4058075122185	Folding box 1	69 mm x 1,464 mm x 77 mm	1900.00 g	7.78 dm <sup>3</sup>
4058075122192	Shipping box 6	1,474 mm x 225 mm x 170 mm	13360.00 g	56.38 dm <sup>3</sup>

The mentioned product code describes the smallest quantity unit which can be ordered. One shipping unit can contain one or more single products. When placing an order, for the quantity please enter single or multiples of a shipping unit.

---

### ADDITIONAL CATALOG INFORMATION

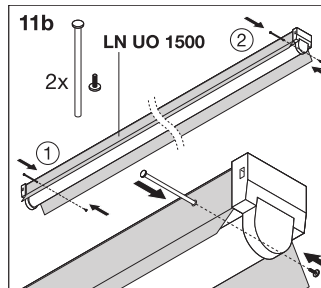
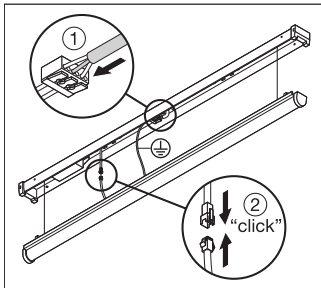

### References / Links

– For Guarantee see [www.ledvance.com/guarantee](http://www.ledvance.com/guarantee)

---

### DISCLAIMER

Subject to change without notice. Errors and omission excepted. Always make sure to use the most recent release.